

CHRISTOPHER HODGSON



**Whitstable**  
**£295,000** Freehold

FOR COASTAL, COUNTRY  
& CITY LIVING

---

# Whitstable

*81 Sydenham Street, Whitstable, Kent, CT5 1HL*

A spacious Victorian terraced house enviably positioned within the heart of Whitstable's desirable conservation area, moments from Harbour Street with its boutique shops and highly regarded eateries, the beach, working harbour and Whitstable station (0.4 miles).

The property now requires a programme of refurbishment throughout and has considerable scope for extension and remodelling (subject to obtaining all necessary consent and approvals).

The comfortably proportioned accommodation is currently arranged on the ground floor to provide an open-plan sitting/dining room, a kitchen, and a utility area. To the first floor there are two double bedrooms and a bathroom.

The rear garden extends to 53ft (10.67m) and benefits from pedestrian access to the rear via Stream Walk. No onward chain.



## LOCATION

Sydenham Street is a highly desirable location within the town's sought after conservation area in central Whitstable and easily accessible to shops, bus routes and station. Whitstable is an increasingly popular and fashionable town by the sea offering a good range of amenities including an array of cafe bars, independent shops, highly regarded restaurants, watersports facilities and working harbour. The mainline railway station is just moments away, providing fast and frequent links to London (Victoria) approximately 80 minutes. The high speed Javelin service provides access to London (St Pancras) with a journey time of approximately 73 minutes. The A299 is accessible providing a dual carriageway link to the M2/A2 giving access to the channel ports and connecting motorway network.

## ACCOMMODATION

The accommodation and approximate measurements (taken at maximum points) are:

### GROUND FLOOR

- Living Room 23'3" x 11'5" (7.10m x 3.48m)
- Kitchen 9'9" x 6'9" (2.98m x 2.07m)

### FIRST FLOOR

- Bedroom 1 11'5" x 10'0" (3.48m x 3.05m)
- Bedroom 2 11'5" x 10'1" (3.48m x 3.08m)
- Bathroom 9'7" x 6'9" (2.94m x 2.07m)

### OUTSIDE

- Garden 35" x 12" (10.67m x 3.66m)









### Ground Floor

Approx. 33.3 sq. metres (358.6 sq. feet)

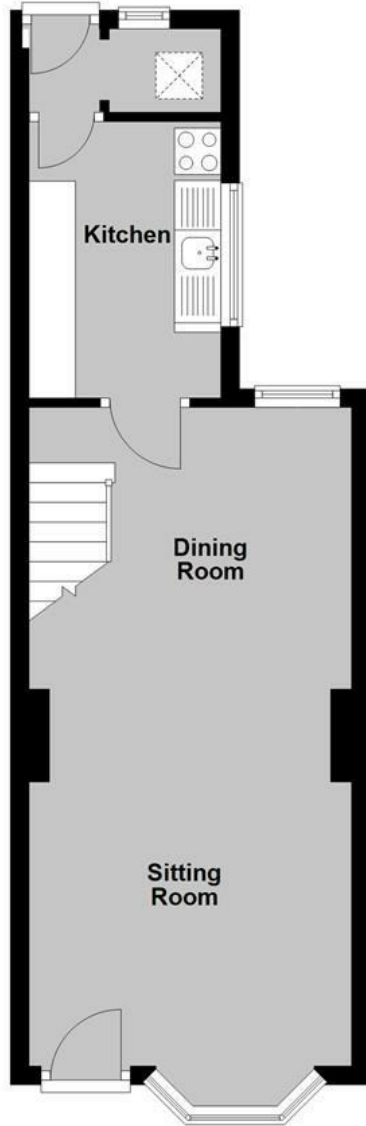

### First Floor

Approx. 30.8 sq. metres (332.0 sq. feet)

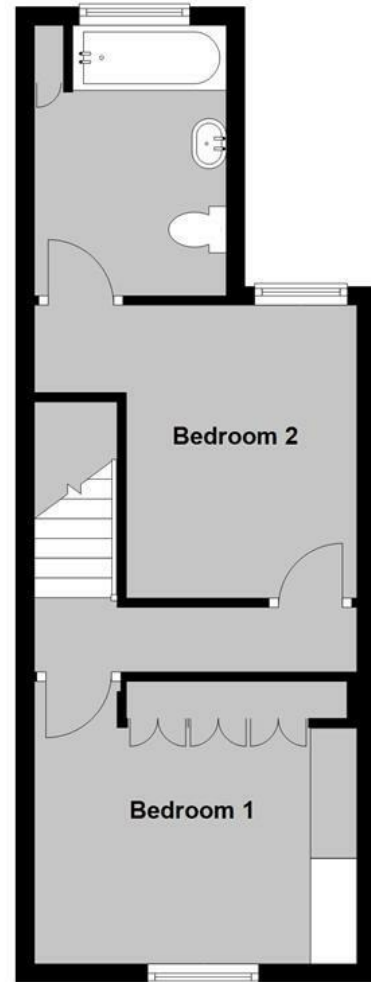

Total area: approx. 64.2 sq. metres (690.6 sq. feet)

**Council Tax Band B. The amount payable under tax band B for the year 2025/2026 is £1,791.42.**

Christopher Hodgson Estate Agents for itself and as for the vendor or lessor (as appropriate) gives notice that: 1 These particulars are only a general outline for the guidance of intending purchasers or lessees and do not constitute in whole or in part an offer or a Contract. 2 Reasonable endeavours have been made to ensure that the information given in these particulars is materially correct but any intending purchaser or lessee should satisfy themselves by inspection, searches, enquiries and survey as to the correctness of each statement. 3 All statements in these particulars are made without responsibility on the part of Christopher Hodgson Estate Agents or the vendor or lessor. 4 No statement in these particulars is to be relied upon as a statement or representation of fact. 5 Neither Christopher Hodgson Estate Agents nor anyone in its employment or acting on its behalf has authority to make any representation or warranty in relation to this property. 6 Nothing in these particulars shall be deemed to be a statement that the property is in good repair or condition or otherwise nor that any services or facilities are in good working order. 7 Photographs may show only certain parts and aspects of the property at the time when the photographs were taken and you should rely upon actual inspection. 8 No assumption should be made in respect of parts of the property not shown in photographs. 9 Any areas, measurements or distances are only approximate. 10 Any reference to alterations or use is not intended to be a statement that any necessary planning, building regulation, listed building or any other consent has been obtained. 11 Amounts quoted are exclusive of VAT if applicable. 12 Whilst reasonable endeavours have been made to ensure the accuracy of any floor plan contained in these particulars, all measurements and areas are approximate and no responsibility is taken for any error, omission or mis-statement. This plan is for illustrative purposes only and should be used as such by any prospective purchaser. 13 Any mapping contained within these particulars is for illustrative purposes only and should be used as such by any prospective purchaser. No responsibility is taken for any error, omission or mis-statement. 14 Any computer generated images contained within these particulars are for illustrative purposes only and should be used as such by any prospective purchaser.

Energy Efficiency Rating	
Energy efficient - lower rating costs	Energy efficient - higher rating costs
Energy A	78
Energy B	73
Energy C	68
Energy D	63
Energy E	58
Energy F	53
Energy G	48
Energy H	43
Energy I	38
Energy J	33
Energy K	28
Energy L	23
Energy M	18
Energy N	13
Energy O	8
Energy P	3
Energy Q	-2
Energy R	-7
Energy S	-12
Energy T	-17
Energy U	-22
Energy V	-27
Energy W	-32
Energy X	-37
Energy Y	-42
Energy Z	-47
Energy AA	-52
Energy AB	-57
Energy AC	-62
Energy AD	-67
Energy AE	-72
Energy AF	-77
Energy AG	-82
Energy AH	-87
Energy AI	-92
Energy AJ	-97
Energy AK	-102
Energy AL	-107
Energy AM	-112
Energy AN	-117
Energy AO	-122
Energy AP	-127
Energy AQ	-132
Energy AR	-137
Energy AS	-142
Energy AT	-147
Energy AU	-152
Energy AV	-157
Energy AW	-162
Energy AX	-167
Energy AY	-172
Energy AZ	-177
Energy BA	-182
Energy BB	-187
Energy BC	-192
Energy BD	-197
Energy BE	-202
Energy BF	-207
Energy BG	-212
Energy BH	-217
Energy BI	-222
Energy BJ	-227
Energy BK	-232
Energy BL	-237
Energy BM	-242
Energy BN	-247
Energy BO	-252
Energy BP	-257
Energy BQ	-262
Energy BR	-267
Energy BS	-272
Energy BT	-277
Energy BU	-282
Energy BV	-287
Energy BW	-292
Energy BX	-297
Energy BY	-302
Energy BZ	-307
Energy CA	-312
Energy CB	-317
Energy CC	-322
Energy CD	-327
Energy CE	-332
Energy CF	-337
Energy CG	-342
Energy CH	-347
Energy CI	-352
Energy CJ	-357
Energy CK	-362
Energy CL	-367
Energy CM	-372
Energy CN	-377
Energy CO	-382
Energy CP	-387
Energy CQ	-392
Energy CR	-397
Energy CS	-402
Energy CT	-407
Energy CU	-412
Energy CV	-417
Energy CW	-422
Energy CX	-427
Energy CY	-432
Energy CZ	-437
Energy DA	-442
Energy DB	-447
Energy DC	-452
Energy DD	-457
Energy DE	-462
Energy DF	-467
Energy DG	-472
Energy DH	-477
Energy DI	-482
Energy DJ	-487
Energy DK	-492
Energy DL	-497
Energy DM	-502
Energy DN	-507
Energy DO	-512
Energy DP	-517
Energy DQ	-522
Energy DR	-527
Energy DS	-532
Energy DT	-537
Energy DU	-542
Energy DV	-547
Energy DW	-552
Energy DX	-557
Energy DY	-562
Energy DZ	-567
Energy EA	-572
Energy EB	-577
Energy EC	-582
Energy ED	-587
Energy EE	-592
Energy EF	-597
Energy EG	-602
Energy EH	-607
Energy EI	-612
Energy EJ	-617
Energy EK	-622
Energy EL	-627
Energy EM	-632
Energy EN	-637
Energy EO	-642
Energy EP	-647
Energy EQ	-652
Energy ER	-657
Energy ES	-662
Energy ET	-667
Energy EU	-672
Energy EV	-677
Energy EW	-682
Energy EX	-687
Energy EY	-692
Energy EZ	-697
Energy FA	-702
Energy FB	-707
Energy FC	-712
Energy FD	-717
Energy FE	-722
Energy FF	-727
Energy FG	-732
Energy FH	-737
Energy FI	-742
Energy FJ	-747
Energy FK	-752
Energy FL	-757
Energy FM	-762
Energy FN	-767
Energy FO	-772
Energy FP	-777
Energy FQ	-782
Energy FR	-787
Energy FS	-792
Energy FT	-797
Energy FU	-802
Energy FV	-807
Energy FW	-812
Energy FX	-817
Energy FY	-822
Energy FZ	-827
Energy GA	-832
Energy GB	-837
Energy GC	-842
Energy GD	-847
Energy GE	-852
Energy GF	-857
Energy GG	-862
Energy GH	-867
Energy GI	-872
Energy GJ	-877
Energy GK	-882
Energy GL	-887
Energy GM	-892
Energy GN	-897
Energy GO	-902
Energy GP	-907
Energy GQ	-912
Energy GR	-917
Energy GS	-922
Energy GT	-927
Energy GU	-932
Energy GV	-937
Energy GW	-942
Energy GX	-947
Energy GY	-952
Energy GZ	-957
Energy HA	-962
Energy HB	-967
Energy HC	-972
Energy HD	-977
Energy HE	-982
Energy HF	-987
Energy HG	-992
Energy HH	-997
Energy HI	-1002
Energy HJ	-1007
Energy HK	-1012
Energy HL	-1017
Energy HM	-1022
Energy HN	-1027
Energy HO	-1032
Energy HP	-1037
Energy HQ	-1042
Energy HR	-1047
Energy HS	-1052
Energy HT	-1057
Energy HU	-1062
Energy HV	-1067
Energy HW	-1072
Energy HX	-1077
Energy HY	-1082
Energy HZ	-1087
Energy IA	-1092
Energy IB	-1097
Energy IC	-1102
Energy ID	-1107
Energy IE	-1112
Energy IF	-1117
Energy IG	-1122
Energy IH	-1127
Energy II	-1132
Energy IJ	-1137
Energy IK	-1142
Energy IL	-1147
Energy IM	-1152
Energy IN	-1157
Energy IO	-1162
Energy IP	-1167
Energy IQ	-1172
Energy IR	-1177
Energy IS	-1182
Energy IT	-1187
Energy IU	-1192
Energy IV	-1197
Energy IW	-1202
Energy IX	-1207
Energy IY	-1212
Energy IZ	-1217
Energy JA	-1222
Energy JB	-1227
Energy JC	-1232
Energy JD	-1237
Energy JE	-1242
Energy JF	-1247
Energy JG	-1252
Energy JH	-1257
Energy JI	-1262
Energy JJ	-1267
Energy JK	-1272
Energy JL	-1277
Energy JM	-1282
Energy JN	-1287
Energy JO	-1292
Energy JP	-1297
Energy JQ	-1302
Energy JR	-1307
Energy JS	-1312
Energy JT	-1317
Energy JU	-1322
Energy JV	-1327
Energy JW	-1332
Energy JX	-1337
Energy JY	-1342
Energy JZ	-1347
Energy KA	-1352
Energy KB	-1357
Energy KC	-1362
Energy KD	-1367
Energy KE	-1372
Energy KF	-1377
Energy KG	-1382
Energy KH	-1387
Energy KI	-1392
Energy KJ	-1397
Energy KK	-1402
Energy KL	-1407
Energy KM	-1412
Energy KN	-1417
Energy KO	-1422
Energy KP	-1427
Energy KQ	-1432
Energy KR	-1437
Energy KS	-1442
Energy KT	-1447
Energy KU	-1452
Energy KV	-1457
Energy KW	-1462
Energy KX	-1467
Energy KY	-1472
Energy KZ	-1477
Energy LA	-1482
Energy LB	-1487
Energy LC	-1492
Energy LD	-1497
Energy LE	-1502
Energy LF	-1507
Energy LG	-1512
Energy LH	-1517
Energy LI	-1522
Energy LJ	-1527
Energy LK	-1532
Energy LL	-1537
Energy LM	-1542
Energy LN	-1547
Energy LO	-1552
Energy LP	-1557
Energy LQ	-1562
Energy LR	-1567
Energy LS	-1572
Energy LT	-1577
Energy LU	-1582
Energy LV	-1587
Energy LW	-1592
Energy LX	-1597
Energy LY	-1602
Energy LZ	-1607
Energy MA	-1612
Energy MB	-1617
Energy MC	-1622
Energy MD	-1627
Energy ME	-1632
Energy MF	-1637
Energy MG	-1642
Energy MH	-1647
Energy MI	-1652
Energy MJ	-1657
Energy MK	-1662
Energy ML	-1667
Energy MM	-1672
Energy MN	-1677
Energy MO	-1682
Energy MP	-1687
Energy MQ	-1692
Energy MR	-1697
Energy MS	-1702
Energy MT	-1707
Energy MU	-1712
Energy MV	-1717
Energy MW	-1722
Energy MX	-1727
Energy MY	-1732
Energy MZ	-1737
Energy NA	-1742
Energy NB	-1747
Energy NC	-1752
Energy ND	-1757
Energy NE	-1762
Energy NF	-1767
Energy NG	-1772
Energy NH	-1777
Energy NI	-1782
Energy NJ	-1787
Energy NK	-1792
Energy NL	-1797
Energy NO	-1802
Energy NP	-1807
Energy NQ	-1812
Energy NR	-1817
Energy NS	-1822
Energy NT	-1827
Energy NU	-1832
Energy NV	-1837
Energy NW	-1842
Energy NX	-1847
Energy NY	-1852
Energy NZ	-1857
Energy OA	-1862
Energy OB	-1867
Energy OC	-1872
Energy OD	-1877
Energy OE	-1882
Energy OF	-1887
Energy OG	-1892
Energy OH	-1897
Energy OI	-1902
Energy OJ	-1907
Energy OK	-1912
Energy OL	-1917
Energy OM	-1922
Energy ON	-1927
Energy OO	-1932
Energy OP	-1937
Energy OQ	-1942
Energy OR	-1947
Energy OS	-1952
Energy OT	-1957
Energy OU	-1962
Energy OV	-1967
Energy OW	-1972
Energy OX	-1977
Energy OY	-1982
Energy OZ	-1987
Energy PA	-1992
Energy PB	-1997
Energy PC	-2002
Energy PD	-2007
Energy PE	-2012
Energy PF	-2017
Energy PG	-2022
Energy PH	-2027
Energy PI	-2032
Energy PJ	-2037
Energy PK	-2042
Energy PL	-2047
Energy PM	-2052
Energy PN	-2057
Energy PO	-2062
Energy PP	-2067
Energy PQ	-2072
Energy PR	-2077
Energy PS	-2082
Energy PT	-2087
Energy PU	-2092
Energy PV	-2097
Energy PW	-2102
Energy PX	-2107
Energy PY	-2112
Energy PZ	-2117
Energy QA	-2122
Energy QB	-2127
Energy QC	-2132
Energy QD	-2137
Energy QE	-2142
Energy QF	-2147
Energy QG	-2152
Energy QH	-2157
Energy QI	-2162
Energy QJ	-2167
Energy QK	-2172
Energy QL	-2177
Energy QM	-2182
Energy QN	-2187
Energy QO	-2192
Energy QP	-2197
Energy QQ	-2202
Energy QR	-2207
Energy QS	-2212
Energy QT	-2217
Energy QU	-2222
Energy QV	-2227
Energy QW	-2232
Energy QX	-2237
Energy QY	-2242
Energy QZ	-2247
Energy RA	-2252
Energy RB	-2257
Energy RC	-2262
Energy RD	-2267
Energy RE	-2272
Energy RF	-2277
Energy RG	-2282
Energy RH	-2287
Energy RI	-2292
Energy RJ	-2297
Energy RK	-2302
Energy RL	-2307
Energy RM	-2312
Energy RN	-2317
Energy RO	-2322
Energy RP	-2327
Energy RQ	-2332
Energy RR	-2337
Energy RS	-2342
Energy RT	-2347
Energy RU	-2352
Energy RV	-2357
Energy RW	-2362
Energy RX	-2367
Energy RY	-2372
Energy RZ	-2377
Energy SA	-2382
Energy SB	-2387
Energy SC	-2392
Energy SD	-2397
Energy SE	-2402
Energy SF	-2407
Energy SG	-2412
Energy SH	-2417
Energy SI	-2422
Energy SJ	-2427
Energy SK	-2432
Energy SL	-2437
Energy SM	-2442
Energy SN	-2447
Energy SO	-2452
Energy SP	-2457
Energy SQ	-2462
Energy SR	-2467
Energy SS	-2472
Energy ST	-2477
Energy SU	-2482
Energy SV	-2487
Energy SW	-2492
Energy SX	-2497
Energy SY	-2502
Energy SZ	-2507
Energy TA	-2512
Energy TB	-2517
Energy TC	-2522
Energy TD	-2527
Energy TE	-2532
Energy TF	-2537
Energy TG	-2542
Energy TH	-2547
Energy TI	-2552
Energy TJ	-2557
Energy TK	-2562
Energy TL	-2567
Energy TM	-2572
Energy TN	-2577
Energy TO	-2582
Energy TP	-2587
Energy TQ	-2592
Energy TR	-2597
Energy TS	-2602
Energy TT	-2607
Energy TU	-2612
Energy TV	-2617
Energy TW	-2622
Energy TX	-2627
Energy TY	-2632
Energy TZ	-2637
Energy UA	-2642
Energy UB	-2647
Energy UC	-2652
Energy UD	-2657
Energy UE	-2662
Energy UF	-2667
Energy UG	-2672
Energy UH	-2677
Energy UI	-2682
Energy UJ	-2687
Energy UK	-2692
Energy UL	-2697
Energy UM	-2702
Energy UN	-2707
Energy UO	-2712
Energy UP	-2717
Energy UQ	-2722
Energy UR	-2727
Energy US	-2732
Energy UT	-2737
Energy UU	-2742
Energy UV	-2747
Energy UW	-2752
Energy UX	-2757
Energy UY	-2762
Energy UZ	-2767
Energy VA	-2772
Energy VB	-2777
Energy VC	-2782
Energy VD	-2787